

# Delivery specification

## E-Cap Conduit for protection cap

N i s s i n k o u g y o u s y o CO, LTD

〒553-0002

Osakasi fukusimaku sagisu 5tyoume2ban5gou

TEL 06-6458-8161

FAX 06-6458-8165

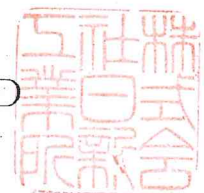

# E - c a p

Material: low-density polyethylene

color: grey (For thin steel conduit)

green (For thick steel conduit)

Raw materials properties Data table

	Test items	Test method	unit	
Fundamental nature	melt index	JIS K 6760	g/10min	25
	density	JIS K 6760	g/cm <sup>3</sup>	0.915
mechanical nature	Tensile Yield strength	JIS K 6760	kg/cm <sup>2</sup>	90
	Breaking strength tensile	JIS K 6760	kg/cm <sup>2</sup>	70
	Tensile modulus	JIS K 6760	kg/cm <sup>2</sup>	3,200
	Tensile elongation at break	JIS K 6760	%	440
	Olsen made of steel	JIS K 7106	kg/cm <sup>2</sup>	1,800
	Tensile impact strength	ASTM D 1822	kg · cm/cm <sup>2</sup>	140
	Shore Hardness	JIS K 7215	(D scale)	47
Thermal property	Vicat softening point	JIS K 7206	°C	88
	Melting points		°C	120
Chemistry	ESCR	JIS K 6760	h	8
	ESCR	JIS K 6760	h	8

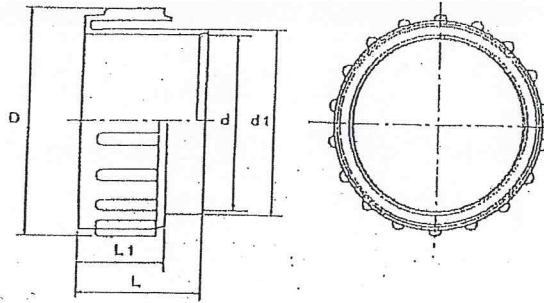

For thin Steel wiretube(Grey)

Unit:m/m

E-cap size	The dimensions of each part					Applicable Wire tube
	D	d	d1	L	L1	
19	22.3	13.6	15.5	18.3	15.3	C19, E19
25	30.5	18.6	21.8	24.0	18.0	C25, E25
31	37.3	24.0	27.5	25.5	21.6	C31, E31
39	44.0	30.3	34.8	32.0	27.0	C39, E39
51	57.0	42.5	46.5	33.4	28.6	C51, E51
63	71.3	55.0	59.0	37.3	32.3	C63, E63
75	84.0	65.5	71.0	49.7	40.0	C75, E75

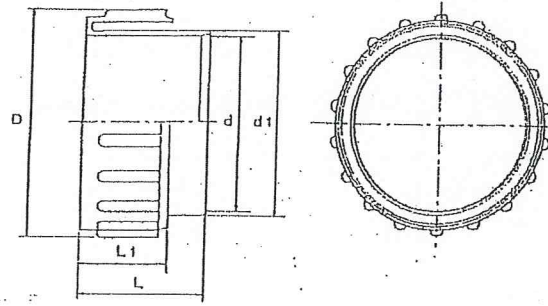

For thick Steel conduit(Green)

Unit:m/m

E-cap size	The dimensions of each part					Applicable Wire tube
	D	d	d1	L	L1	
16	25.6	14.0	15.5	23.6	20.3	G16
22	31.4	19.5	21.5	25.6	22.5	G22
28	38.3	25.5	28.0	30.8	25.5	G28
36	47.7	32.8	36.0	35.2	30.3	G36
42	53.6	38.0	42.3	35.4	30.4	G42
54	67.5	49.5	53.4	40.3	33.1	G54
70	82.2	63.5	69.0	44.5	38.7	G70
82	95.5	76.0	81.7	45.0	35.0	G82
92	110.0	85.0	93.0	59.2	41.5	G92
104	124.4	98.0	105.7	70.0	44.8	G104